

DESCRIPTION

Flocculant is stored in the lower (AUTOLIFT) hopper that feeds the screw conveyor to carry the product up. Once the product is in the screw conveyor, it is carried to an outlet that is angled 45° downwards and connected by a flexible collar to the upper hopper (on the AUTOFLOC). The level sensor in the upper hopper drives the screw conveyor motor to make sure there is always some product in the AUTOFLOC metering hopper.

SPECIFICATIONS

- One 200-litre lower hopper with a cover and a sack grate.
- 1 screw conveyor designed for the height of the AUTOFLOC hopper
- 1 control cabinet containing all the information
- 1 powder level sensor in the upper hopper

BENEFITS

- No need to build a costly and cumbersome walkway
- Significantly easy to use
- Safer
- Constant filling of the receiving hopper for more precise dosing
- Can be loaded from big-bags
- Straightforward fitting/removal of the screw
- Easier maintenance with a shutoff damper

OPTIONAL

- 500, 1,000, 1,500, 2,000 and 3,000 L hopper
- Ø 300 mm big-bag filler port
- Low-level sensor on the hopper
- Hopper vibrating system

IMPORTANT NOTICE

The AUTOLIFT system can very easily be fitted to AUTOFLOC stations currently in service, simply by replacing the upper hopper cover with the model that has the powder level sensor.



TECHNICAL DATA

> Drawing for illustration purposes

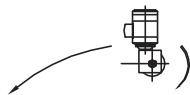
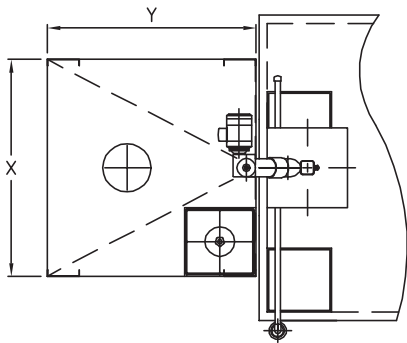
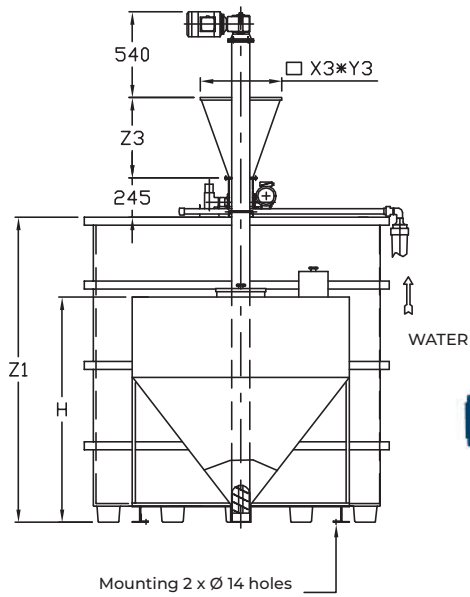
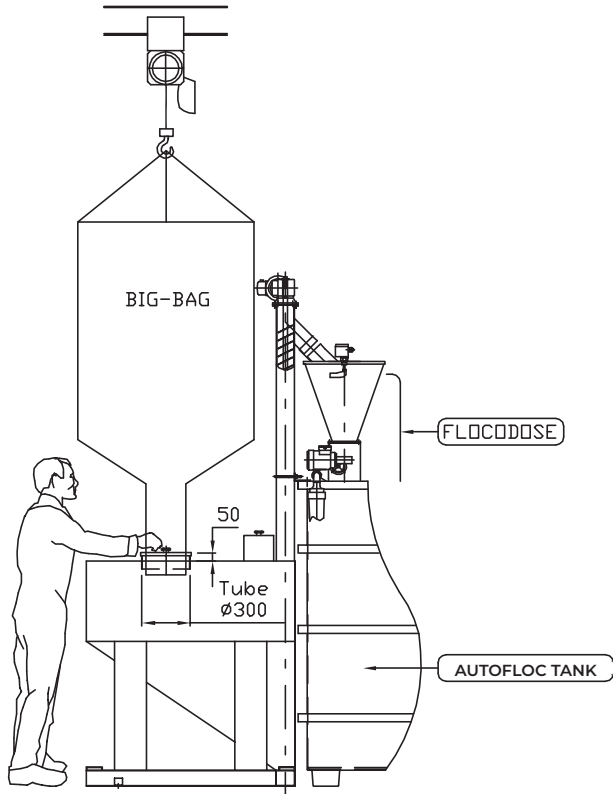

Direction of rotation

Type	Volume (L)	Dimensions		
		Length	Widt	Hopper height
A200	200	1200	900	1032
A500	500	1400	1050	1200
A1000	1000	1400	1600	1760
A1500	1500	1400	1600	2110
A2000	2000	1400	1710	2010

The height of the powder conveyor is per your requirements

